

John Stoner.

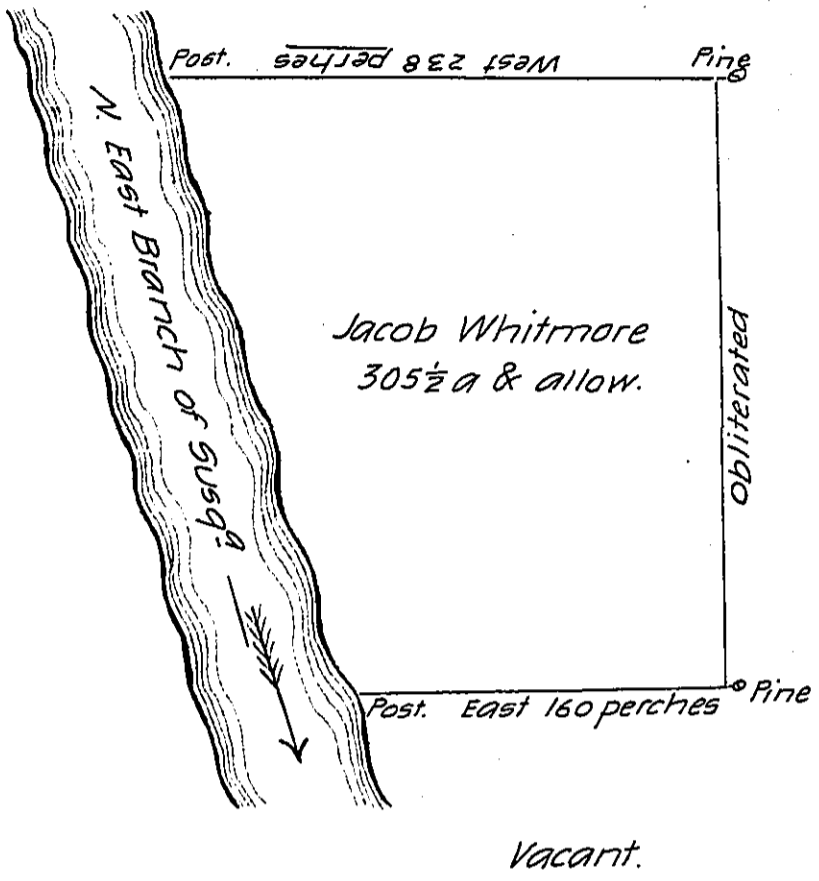

A Draught of a tract of land called _____ Situate on the
 South East Side of the North East Branch of Susquehanna River
 about two miles above the mouth of Tibago in the County of North-
 umberland Containing three hundred and five acres & a half besides
 the usual allowance of 6 P Cent for roads & to Surveyed the 23^d
 day of September 1773 for Jacob Whitmore In pursuance of an order
 dated the 3^d day of April 1769 Number 25. by

Chas Stewart D^y Sur^r

To John Lukens Esqr.

Survey^r Gen^l

IN TESTIMONY that the above is a copy of the original remaining on file in
 the Department of Internal Affairs of Pennsylvania, made
 conformably to an Act of Assembly approved the 16th day of
 February, 1833, I have hereunto set my Hand and caused
 the Seal of said Department to be affixed at Harrisburg,
 this sixteenth day of April 1906

Leach R. Brown
 Secretary of Internal Affairs.